

PAGES: 4

ORDINANCE 14-17

**AN ORDINANCE ANNEXING THE DIETRICH PROPERTY,
CONSISTING OF APPROXIMATELY 80 ACRES OF LAND
LOCATED SOUTHEAST OF 7000N ROAD AND 1000E ROAD TO
THE VILLAGE OF MANTENO, KANKAKEE COUNTY, ILLINOIS**

TIMOTHY O. NUGENT

Village President

**TIMOTHY J. BOYCE
TODD CROCKETT
DIANE DOLE
JOEL GESKY
SAMUEL MARTIN
WENDELL PHILLIPS**

Trustees

ALISA BLANCHETTE

Village Clerk

**Prepared by
LOUIS F. CANKAR, LTD.
Village Attorney**

ORDINANCE NO. 14-17

AN ORDINANCE ANNEXING THE DIETRICH PROPERTY, CONSISTING OF APPROXIMATELY 80 ACRES OF LAND LOCATED SOUTHEAST OF 7000N ROAD AND 1000E ROAD TO THE VILLAGE OF MANTENO, KANKAKEE COUNTY, ILLINOIS

WHEREAS, a written petition signed by Gary Dietrich and Karen Dietrich, sole legal owners of record of all land within the territory hereinafter described, has been filed with the Village Clerk of the Village of Manteno, Kankakee County, Illinois, requesting that said territory be annexed to the Village of Manteno, Kankakee County, Illinois; and

WHEREAS, no electors reside within the territory hereinafter described;

WHEREAS, the said territory is not within the corporate limits of any municipality but is contiguous to the Village of Manteno;

WHEREAS, the legal owners of record of said territory and the Village of Manteno have entered into a valid and binding annexation agreement relating to such territory;

WHEREAS, all petitions, documents, and other necessary legal requirements are in full compliance with the terms of the annexation agreement and with the statutes of the State of Illinois, specifically Section 7-1-8 of the Illinois Municipal Code; and

WHEREAS, it is in the best interests of the Village of Manteno that the territory be annexed.

NOW, THEREFORE, BE IT ORDAINED by the Village President and Board of Trustees of the Village of Manteno, as follows:

Section 1

That the territory known as the Dietrich Property, consisting of approximately 80 acres of land located southeast of of 7000N Road and 1000E Road, and legally described as follows:

A part of that part of Section 33, Township 32 North, Range 12 East of the Third Principal Meridian, Kankakee County, Illinois lying West of the right-of-way of the Illinois Central Gulf Railroad bounded and described as follows: Commencing at the Northwest corner of the South Half of the Northwest Quarter of said Section 33 and running, thence South 00 degrees 00 minutes 00 seconds East, along the West line of said Section 33, 1296.43 feet to the point of beginning; thence South 00 degrees 00 minutes 00 seconds East, along said West line, 1406.87 feet to a point 1278.55 feet North from the Southwest corner of said Section 33; thence South 89 degrees 49 minutes 03 seconds East, parallel with the North line of the South Half of the Northwest Quarter of Section 33, 2367.37 feet to the westerly

right-of-way line of said railroad; thence North 08 degrees 52 minutes 18 seconds East, along said Westerly line, 1423.20 feet; thence North 89 degrees 49 minutes 03 seconds West, parallel with said North line of the South Half, 2586.86 feet to the point of beginning;

P.I.N.: (03) 02-33-300-012-0000;

being indicated on the plat of annexation attached hereto, is hereby annexed to the Village of Manteno, Kankakee County, Illinois.

Section 2

That the Village Clerk is hereby directed to record and to file with the County Clerk a certified copy of this ordinance.

Section 3

This ordinance shall be in full force and effect after passage and approval as provided for by law.

This ordinance was passed and deposited in the office of the Village Clerk of the Village of Manteno this 2nd day of September, 2014.

AYES: 6

NAYS: 0

ABSTAIN: 0

DEPOSITED with the Village Clerk
this 2nd day of September, 2014.

Alisa Blanchette by Darla Heuley, Deputy
ALISA BLANCHETTE, Village Clerk

APPROVED by me this 2nd
day of September, 2014.

Timothy O. Nugent
TIMOTHY O. NUGENT, Village President

PLAT OF ANNEXATION TO THE VILLAGE OF MANTENO

NW COR OF S 1/2 OF NW 1/4
OF SEC. 33-32-12E

W LINE OF NW 1/4 OF
SEC. 33-32-12E

(S00°00'00"E
1296.43')

(N89°49'03"W 2586.86')

S LINE OF NW 1/4 OF SEC. 33-32-12E

W LINE OF SW 1/4 OF
SEC. 33-32-12E

EAST ROAD

(S00°00'00"E
1406.87')

1000

DIETRICH PROPERTY

(S89°49'03"E 2367.37')

(1278.55')

SW COR OF SEC. 33-32-12E

6000 NORTH ROAD

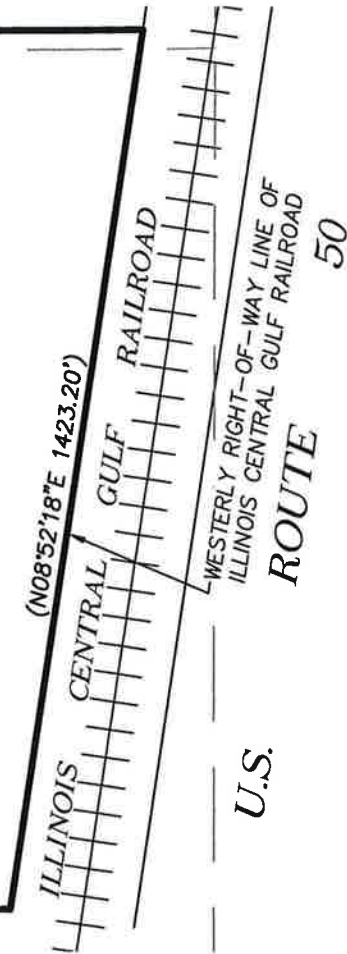

STATE OF ILLINOIS }
COUNTY OF KANKAKEE }SS

WE, M. GINGERICH, GERAUX AND ASSOCIATES DO HEREBY CERTIFY THAT WE PREPARED THIS PLAT OF ANNEXATION AND THAT IS A TRUE AND CORRECT REPRESENTATION OF SAME BASED ON OFFICIAL PLATS AND RECORDS, DISTANCES ARE GIVEN IN FEET AND DECIMALS THEREOF.

DATED THIS 14th DAY OF AUGUST, A.D. 2014.

Mark J. Schierholz

MARK J. SCHIERHOLZ
ILLINOIS PROFESSIONAL LAND SURVEYOR #035-003105
LICENSE EXPIRES NOVEMBER 30, 2014



LAND DESCRIPTION

THAT PART OF SECTION 33, TOWNSHIP 32 NORTH, RANGE 12 EAST OF THIRD PRINCIPAL MERIDIAN, KANKAKEE COUNTY, ILLINOIS LYING WEST OF THE RIGHT-OF-WAY OF THE ILLINOIS CENTRAL GULF RAILROAD BOUNDED AND DESCRIBED AS FOLLOWS: COMMENCING AT THE NORTHWEST CORNER OF THE SOUTH HALF OF THE NORTHWEST QUARTER OF SAID SECTION 33 AND RUNNING, THENCE SOUTH 00 DEGREES 00 MINUTES 00 SECONDS EAST, ALONG THE WEST LINE OF SAID SECTION 33, 1296.43 FEET TO THE POINT OF BEGINNING; THENCE SOUTH 00 DEGREES 00 MINUTES 00 SECONDS EAST, ALONG SAID WEST LINE, 1406.87 FEET TO A POINT 1278.55 FEET NORTH FROM THE SOUTHWEST CORNER OF SAID SECTION 33; THENCE SOUTH 89 DEGREES 49 MINUTES 03 SECONDS EAST, PARALLEL WITH THE NORTH LINE OF THE SOUTH HALF OF THE NORTHWEST QUARTER OF SECTION 33, 2367.37 FEET TO THE WESTERLY RIGHT-OF-WAY LINE OF SAID RAILROAD; THENCE NORTH 08 DEGREES 52 MINUTES 18 SECONDS EAST, ALONG SAID WESTERLY LINE, 1423.20 FEET; THENCE NORTH 89 DEGREES 49 MINUTES 03 SECONDS WEST, PARALLEL WITH SAID NORTH LINE OF THE SOUTH HALF, 2586.86 FEET TO THE POINT OF BEGINNING.



M. GINGERICH, GERAUX & ASSOCIATES		BRADLEY
ENGINEERING * PLANNING		OFFICE
Design Firm No. 184-001808		
Bradley Office 240 N. Industrial Drive Bradley, Illinois 60915 PH. 815-939-4921 FX. 815-939-9810		Manhattan Office 25620 S. Gougar Rd Manhattan, Illinois 60442 PH. 815-478-9680 FX. 815-478-9685
www.mg2a.com		
JOB NO.: 14-060	DR BY: MLZ	